



14 Hopewell Street

, Barnsley, S70 3ET

£160,000



This property is sure to impress! Ideally suited to first-time buyers, downsizers, or young couples, this absolutely stunning stone-fronted end-terrace home is ready to move straight into. Highlights include granite worktops, fully integrated appliances, a charming summerhouse, a private rear garden, and a luxurious four-piece bathroom suite. Don't miss the chance to make this beautifully presented home yours!



GROUND FLOOR

LOUNGE

A fabulously presented lounge featuring laminate flooring and a modern wall-hung feature fire, creating a stylish and cozy atmosphere. The room is further complemented by a radiator and a front-facing double-glazed window, which fills the space with natural light and offers a lovely view of the front elevation.

DINING KITCHEN

This spacious dining kitchen is thoughtfully designed and well-appointed, featuring a range of wall and base units with granite worktops incorporating a sink unit with mixer tap. The kitchen boasts fully integrated appliances and a breakfast island with seating area, making it perfect for modern living. The ceramic tiled flooring adds a sleek touch, while the double-glazed window and French-style doors leading to the rear garden allow natural light to flood the space and provide seamless indoor-outdoor connectivity.

CELLAR

Ideal storage space.

FIRST FLOOR

BEDROOM ONE

A generously proportioned bedroom featuring a front-facing double-glazed window, allowing plenty of natural light, and a radiator for added comfort.

BEDROOM TWO

A double bedroom having a rear facing double glazed window and radiator.

BATHROOM

A four piece suite comprising a shower cubicle, freestanding bath, wc and vanity wash hand basin, being fully tiled with chrome heated ladder rail, a double glazed window with obscure glazing.

OUTSIDE

To the rear, there is a seating area with Indian stone paving, offering a stylish and low-maintenance outdoor space. Additionally, a summerhouse provides a versatile area that can be utilized as a home office, gym, or relaxation space, catering to a variety of needs.

Area Map



Floor Plans

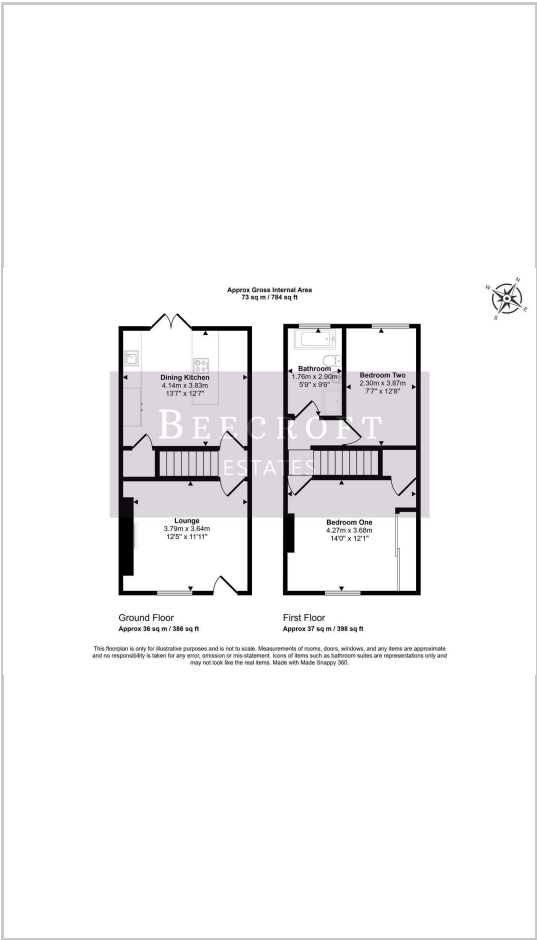

Energy Efficiency Graph

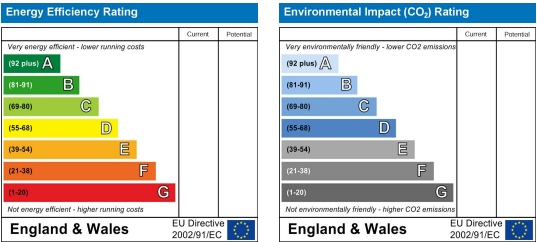

These particulars, whilst believed to be accurate are set out as a general outline only for guidance and do not constitute any part of an offer or contract. Intending purchasers should not rely on them as statements of representation of fact, but must satisfy themselves by inspection or otherwise as to their accuracy. No person in this firms employment has the authority to make or give any representation or warranty in respect of the property.